

PRODUCT NUMBER

10123913-XXXLF

MATERIAL

HOUSING : THERMO PLASTIC UL94V-0 BLACK
CONTACT : COPPER ALLOY
PEG : COPPER ALLOY

PART NO. SCHEMATIC: 10123913 - XX X LF

TERMINAL PLATING _____ PACKING _____
00: NO PLATING 0: TAPE&REEL.STD
G2: GOLD FLASH 1~3μ^m OVER Ni 50~100μ^m 1: TAPE&REEL.RVS
A2: CONTACT AREA AND SOLDER AREA :
SELECTION GOLD 1μ^m OVER Ni 50~100μ^m
A7: CONTACT AND SOLDER TAIL AREA GOLD PLATING
10μ^m MIN OVER Ni 50~100μ^m

PRODUCT SPEC.: GS-12-1111
PACKAGE SPEC.: GS-14-2284

THIS PRODUCT MEETS EUROPEAN UNION DIRECTIVES AND
OTHER COUNTRY REGULATIONS AS DESCRIBED IN GS-47-0004

THE HOUSING WILL WITHSTAND EXPOSURE TO 260°C PEAK
TEMPERATURE FOR 10 SECONDS IN A CONVECTION, IR OR
VAPER PHASE REFLOW OVEN.

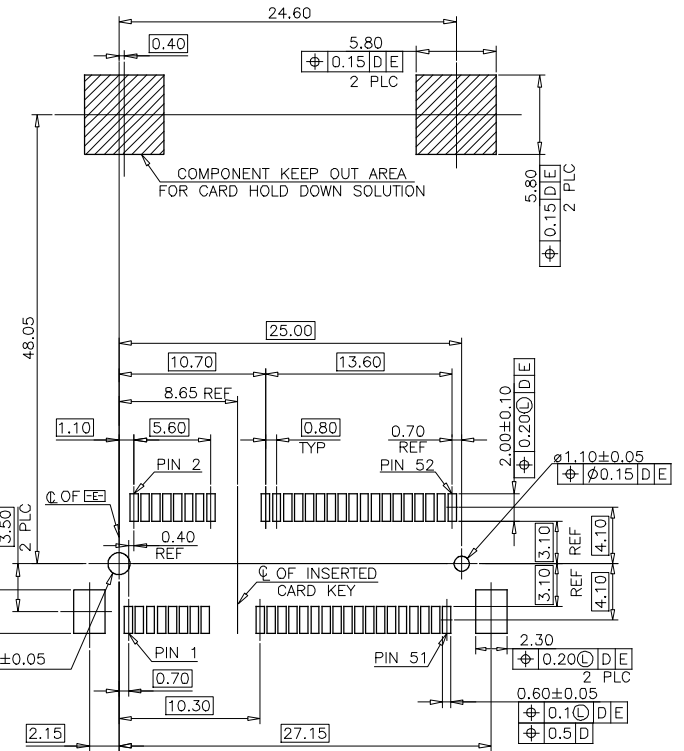
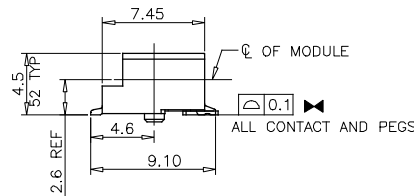
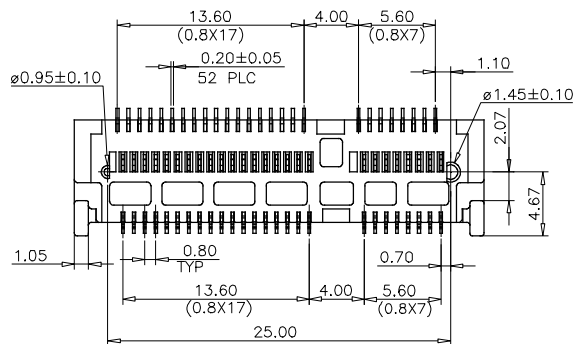
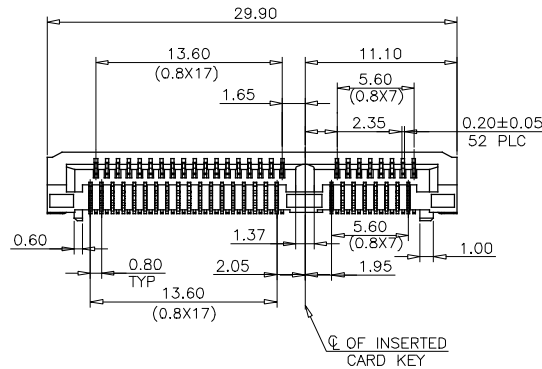
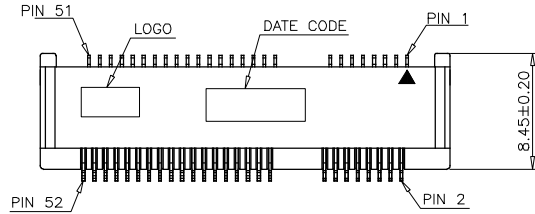

-D- IS THE TOP SURFACE OF PCB
RECOMMENDED P.C.BOARD PATTERN LAYOUT

mat'l. code		surface		tolerance ASME Y14.5		projection		product family	
ltr ecn no dr date		tolerances unless otherwise specified		angles		MM		title	
A TAI 2013-02-20		X.X ± 0.30		X.XX ± 0.20		scale		0.80MM PITCH MINI PCI EXPRESS HIGH=4.5mm 52 PIN CONNECTOR	
		X*±4'		X.XXX ± 0.15				dwg no sheet 1 of 3 size	
		dr KENNY TAI 2013-02-20		enr KENNY TAI 2013-02-20		FCI		10123913 A4	
		chr KENNY TAI 2013-02-20		appd PM ZHENG 2013-02-25				type CUSTOMER Drawing	
sheet index	revision sheet	A 1	A 2	A 3					

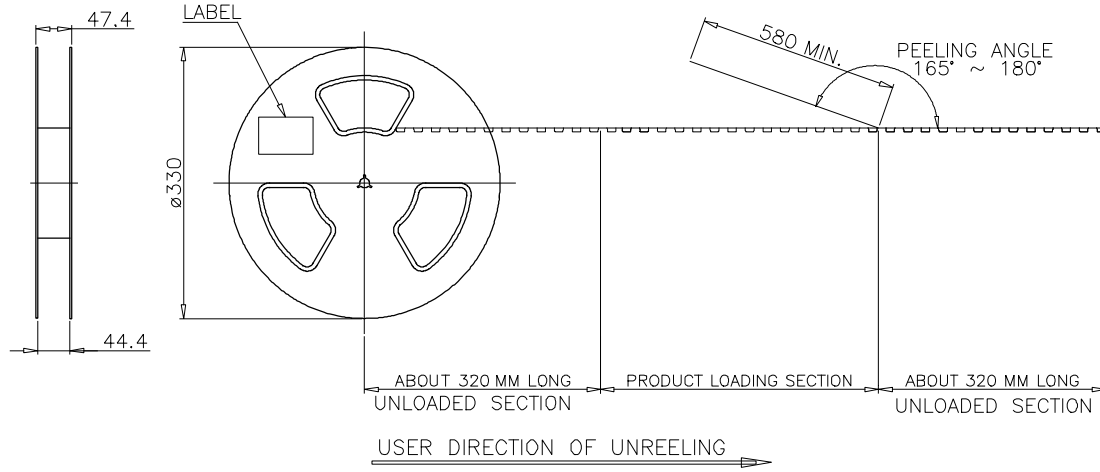

NOTES:

- MATERIAL:
 BOX: FIBREBOARD, CORRUGATED, DOUBLE WALL.
 COVER TAPE: PET, 120°C HEAT-RESISTANT TEMPERATURE, TRANSPARENT COLOR.
 CARRIER TAPE: POLYSTYRENES, 120°C HEAT-RESISTANT TEMPERATURE, TRANSPARENT COLOR.
 REEL: HIPS, 70°C HEAT-RESISTANT TEMPERATURE, BLUE COLOR.
 BAG: POLYETHYLENES, 100°C HEAT-RESISTANT TEMPERATURE, TRANSPARENT COLOR.
- EACH BAG SHALL BE INCLUDED DESICCANT.
- PEELING STRENGTH: 0.1 ~ 1.3 N (10 ~ 130 GRAMS).
- PEELING SPEED: 300 mm/min.

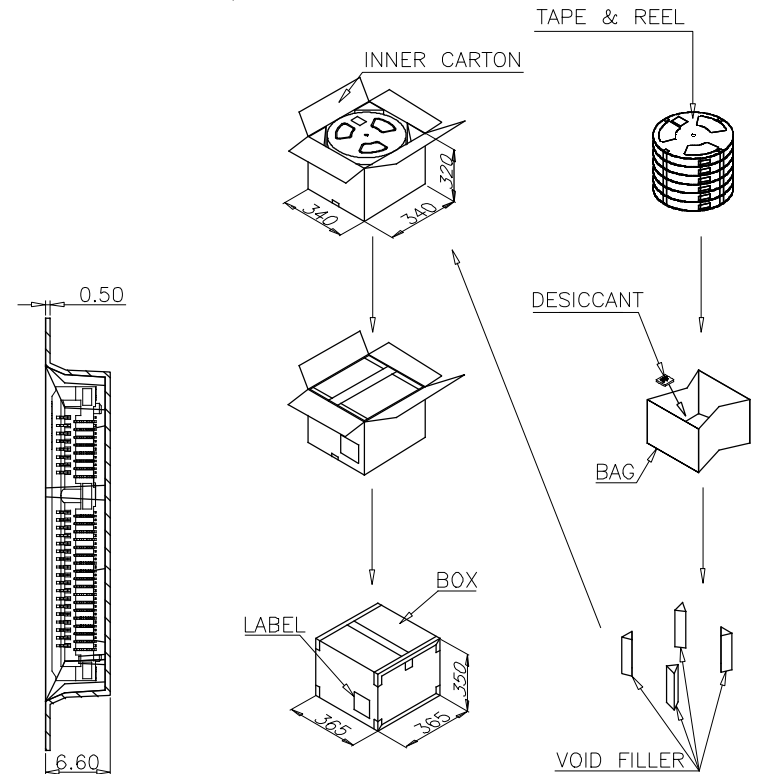
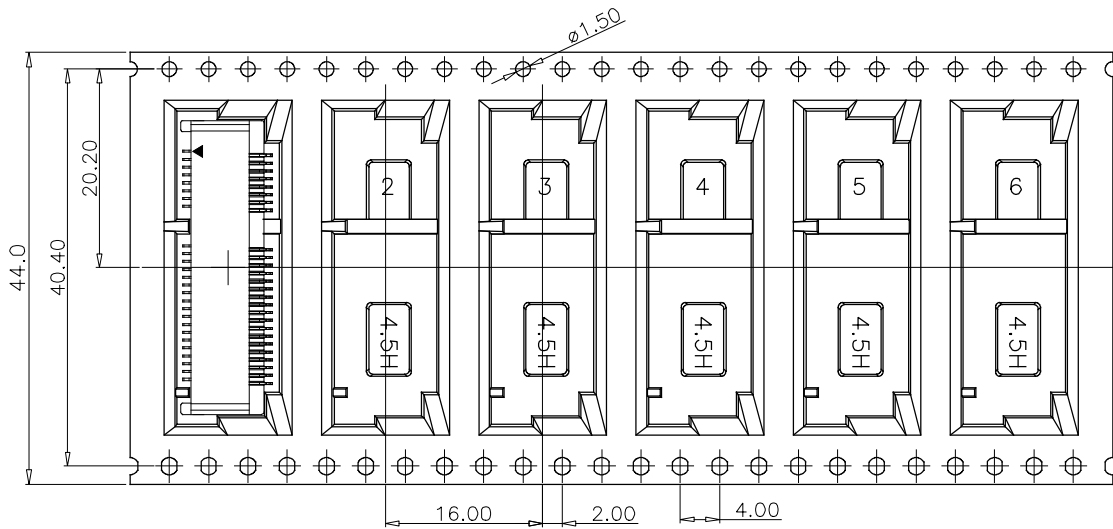

STANDARD TAPE & REEL
(FOR -XX0LF)

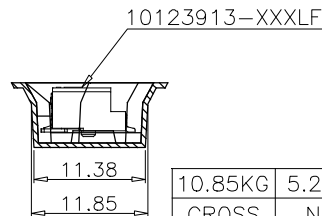

10.85KG	5.27KG	650	6	3900
GROSS WEIGHT	NET WEIGHT	PCS/ REEL	REEL/ BOX	PCS/ BOX

mat'l. code		surface		tolerance ASME Y14.5		projection		product family	
ltr	ecn no	dr	date	tolerances unless otherwise specified		MM		title	
A		TAI	2013-02-20	angles	X.X ± 0.30	← →		0.80MM PITCH MINI PCI EXPRESS HIGH=4.5mm 52 PIN CONNECTOR	
				fil	X.XX ± 0.20	scale		dwg no	
				X*±4°	X.XXX ± 0.15			sheet 2 of 3 size	
				dr	KENNY TAI	2013-02-20		A4	
				enr	KENNY TAI	2013-02-20		10123913	
				chr	KENNY TAI	2013-02-20		type	
				appd	PM ZHENG	2013-02-25		CUSTOMER Drawing	
sheet index	revision sheet	A	A	A					
		1	2	3					

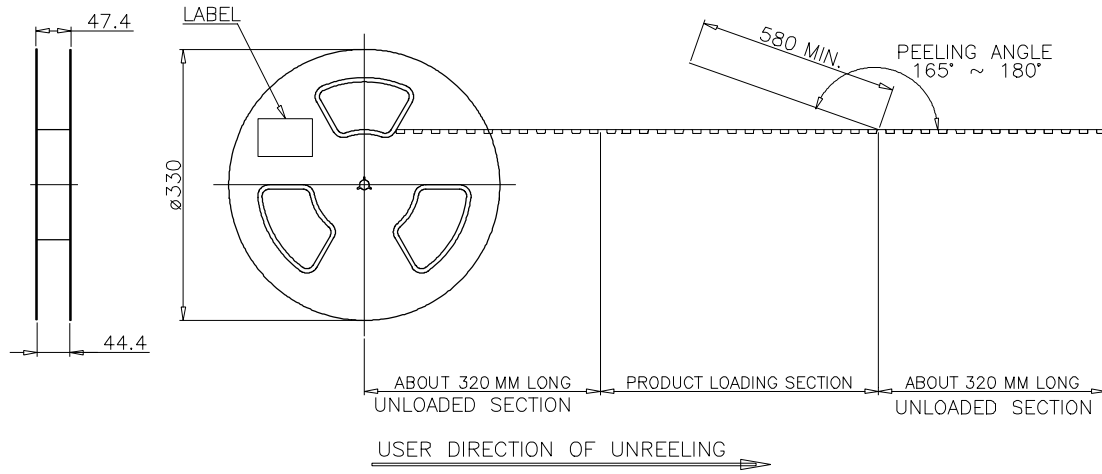

NOTES:

- MATERIAL:
 BOX: FIBREBOARD, CORRUGATED, DOUBLE WALL.
 COVER TAPE: PET, 120C° HEAT-RESISTANT TEMPERATURE, TRANSPARENT COLOR.
 CARRIER TAPE: POLYSTYRENES, 120C° HEAT-RESISTANT TEMPERATURE, TRANSPARENT COLOR.
 REEL: HIPS, 70C° HEAT-RESISTANT TEMPERATURE, BLUE COLOR.
 BAG: POLYETHYLENES, 100C° HEAT-RESISTANT TEMPERATURE, TRANSPARENT COLOR.
- EACH BAG SHALL BE INCLUDED DESICCANT.
- PEELING STRENGTH: 0.1 ~ 1.3 N (10 ~ 130 GRAMS).
- PEELING SPEED: 300 mm/min.

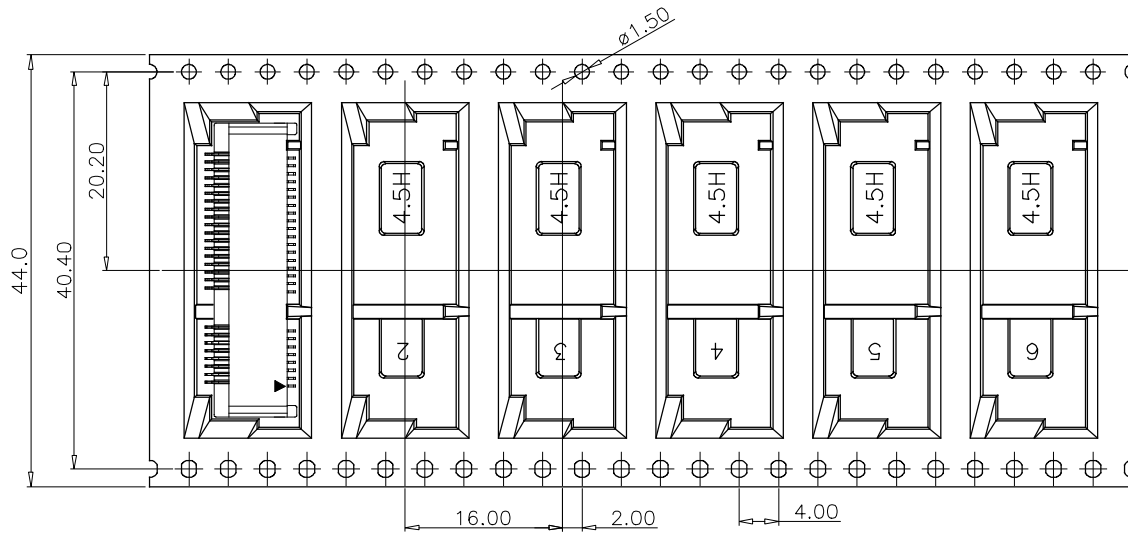

REVERSE TAPE & REEL
(FOR -XX1LF)

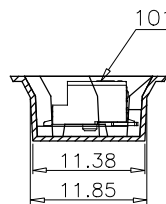

10.85KG	5.27KG	650	6	3900
GROSS WEIGHT	NET WEIGHT	PCS/ REEL	REEL/ BOX	PCS/ BOX

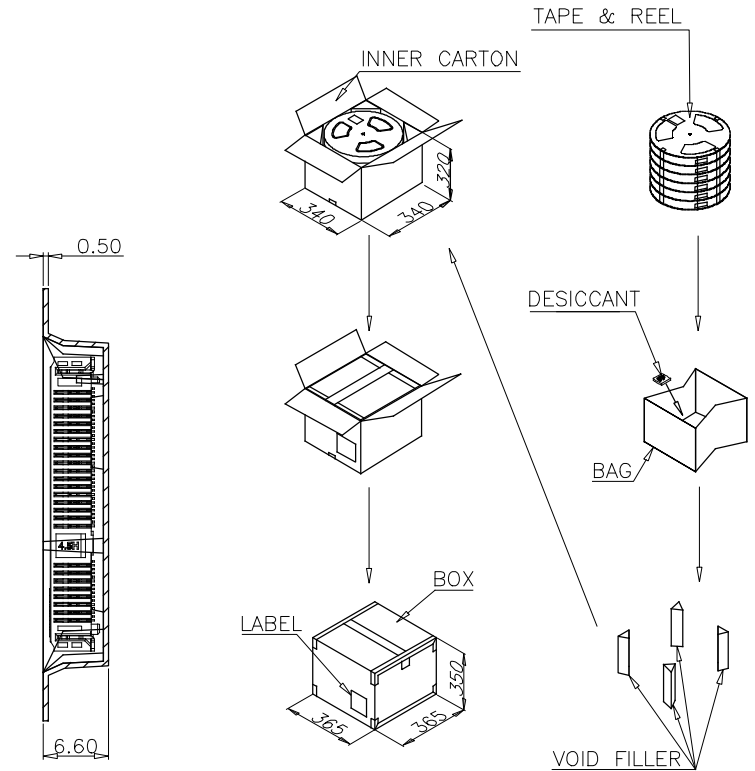

mat'l. code		surface		tolerance <input checked="" type="checkbox"/> ASME Y14.5		projection		product family	
ltr	ecn no	dr	date	tolerances unless otherwise specified		MM		title	
A		TAI	2013-02-20	angles	$X.X \pm 0.30$	MM		0.80MM PITCH MINI PCI EXPRESS HIGH=4.5mm 52 PIN CONNECTOR	
				flatness	$X.XX \pm 0.20$	scale		dwg no	
				$X^{\circ} \pm 4^{\circ}$	$X.XXX \pm 0.15$			sheet 3 of 3 size	
		dr	KENNY TAI	2013-02-20	engr	KENNY TAI	2013-02-20	FCI	
		chr	KENNY TAI	2013-02-20	appd	PM ZHENG	2013-02-25	10123913 A4	
sheet index		revision	A	A	A			type	
		sheet	1	2	3			CUSTOMER Drawing	