

MODEL NUMBER
SHT-2172-MO-SMA-02

REV.
C

NOTES:

- 1.0 MATERIAL:
 - 1.1 HOUSING AND COUPLING NUT: STAINLESS STEEL PER QQ-S-764 AND ASTM-A582, TYPE 303.
 - 1.2 CENTER CONTACT: BERYLLIUM COPPER ROD ALLOY C172 PER ASTM-B196.
 - 1.3 BUSHING: HALF HARD BRASS PER ASTM B16
- 2.0 FINISH:
 - 2.1 HOUSING AND COUPLING NUT: PASSIVATED PER SAE AMS QQ-P-35 AND MIL-F-14072.
 - 2.2 CENTER CONTACT AND BUSHING: GOLD PER MIL-PRF-39012.
- 3.0 DIMENSIONS IN PARENTHESIS ARE MILLIMETERS.
- 4.0 MARK UNIT AS SHOWN.
(REF: INK-09154-27-02)

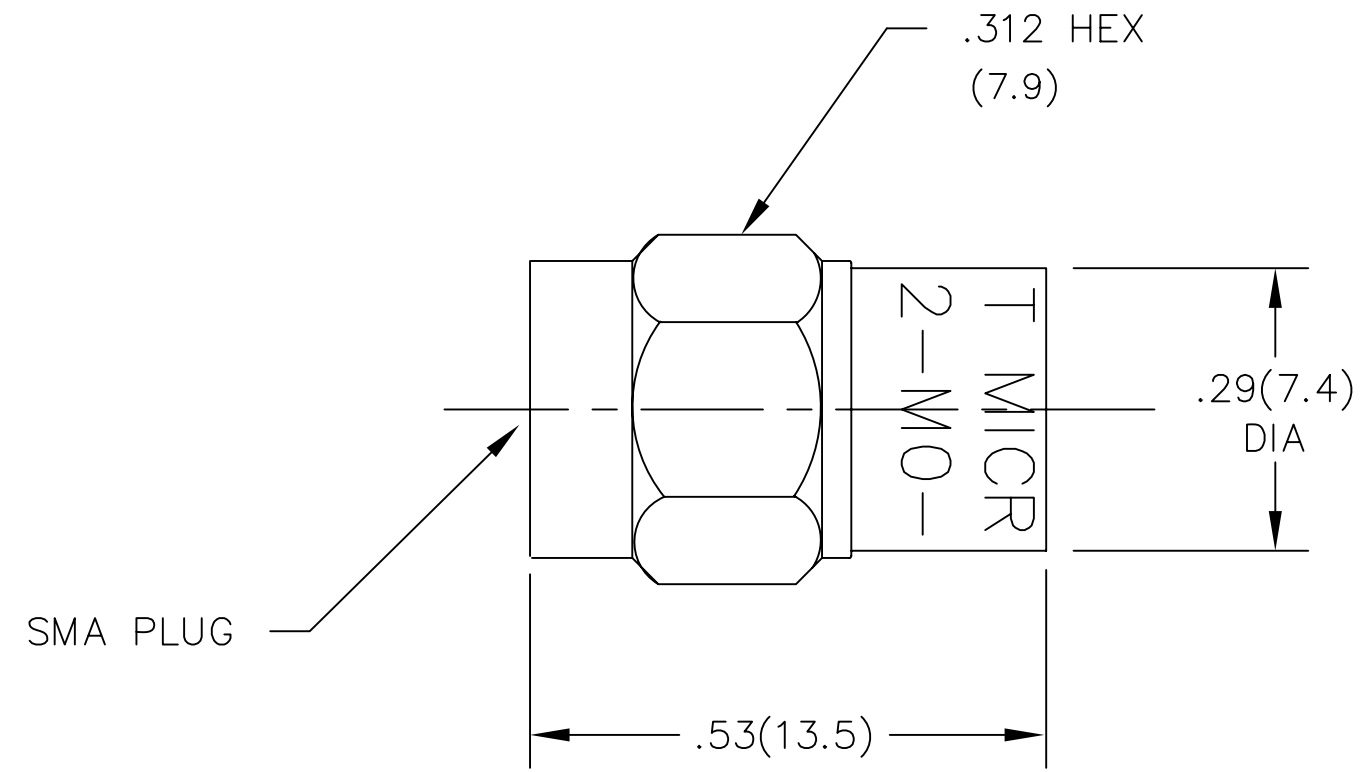

REV.	DESCRIPTION	DATE
-	RELEASED	3/3/92
A	ECN 12113	9/21/92
B	ECN 13044	10/27/93
B1	ADDED TITLEBLOCK	7/21/05
C	ECN 20673	1/27/06

UNLESS OTHERWISE NOTED DIMENSIONS ARE IN INCHES AND TOLERANCES ARE: 3 PLACE DECIMALS ±.005 2 PLACE DECIMALS ±.02 FRACTIONS ±1/64 PARALLELITY: T.I.R. _____ FLATNESS: T.I.R. _____ CONCENTRICITY: T.I.R. _____ ANGLES AND PERPENDICULARITY: ±1°	FSCM NO.	34078 MIDWEST MICROWAVE	
	NOTICE: The information contained in this drawing is proprietary and must not be used without the permission of Midwest Microwave		TITLE
			SMA PLUG SHORT CIRCUIT
	DRAWN/DATE A.BEATTY 2/26/92		ENG./DATE G.KOZAK 3/2/92
CHECKED/DATE A.BEATTY 2/26/92		APPROVED/DATE	SHT-2172-MO-SMA-02
		SCALE: 5=1	SHEET 1 of 1