

Relialign™ CDI Series

Commercial Door Interlock Switch



DESCRIPTION

Honeywell Relialign™ CDI Series Residential Door Interlock switches are electromechanical devices designed for use in swing door applications, specifically dumbwaiters, material lifts, lifts for the mobility impaired and private residence swing-door elevators in the USA. In Canada, the CDI is designed for use in swing door applications, specifically dumbwaiters, material lifts, and residential elevators, but is not designed for use in lifts for the mobility impaired. The interlock holds the door in place and prevents it from being opened in potentially unsafe conditions (e.g. the elevator/lift car is not present at the door). CDI Series interlocks are configurable and available in left- and right-hand versions, allowing for simplified installation, customization, and retrofitting into current designs. A number of design features in the elevator interlock contribute to increase safety, reduce nuisance stoppages and call-backs, and contribute to simplified wiring and installation.

FEATURES

- ASME A17.1, ASME A18.1, cULus, and CAN/CSA B44 compliance
- Two separate mechanical actions to indicate door closure
- Long life of 1 million operations minimum
- Metal key engagement designed to minimize nuisance stoppage with a broad engagement opening
- Door closure retention cam to hold door with minimal key-to-interlock play
- Exceeds commercial pull force standard of 675 pound pull force by 2X
- Internal solenoid control
- No open or exposed contacts
- Manual override for easy actuation without user hazard
- Cat 5 connection available
- Universal voltage for ac and dc applications
- 51,44 mm W x 247,65 mm H x 49,23 mm D [2.025 in W x 9.75 in H x 1.938 in D]

Featuring a custom internal solenoid control, the CDI Series interlock switch can reduce complexity of the host controller, reduce power consumption, extend solenoid life and reduce solenoid “time outs,” reducing customer aggravation. Two snap-action basic switches are used to indicate door closure, providing an extra level of reliability.

Reliability and smooth operation are also enhanced by the use of a metal key that is less susceptible than a plastic key to bending and breakage. The lack of open or exposed contacts minimizes the possibility of owners making manual adjustments. Finally, the engagement of the key initiates electrical contact.

The snap-action cam mechanism reduces adjustment set-up time and reduces door movement that can cause nuisance shutdown. An RJ-45 Category 5 connector option is available, simplifying installation. This door interlock is configurable and available in left- and right-hand versions, allowing for simplified customization. It is designed to be easy for the OEM to retrofit.

BENEFITS

- Meets required safety codes
- Reduces potential for call-backs
- Reliable performance and multiple design features minimize nuisance stoppage
- Simplifies wiring and installation
- Reduces OEM design and manufacturing costs
- Honeywell brand quality

APPLICATIONS

- In the USA: swing door applications, specifically dumbwaiters, material lifts, lifts for the mobility impaired and private residence swing-door elevators
- In Canada: swing door applications, specifically dumbwaiters, material lifts, and residential elevators

Relialign™ CDI Series

TABLE 1. PERFORMANCE SPECIFICATIONS

Characteristic	Measure
Endurance life	1 million operations min.
Operating temperature	4 °C to 38 °C [40 °F to 100 °F]
Storage temperature	-40 °C to 60 °C [-40 °F to 140 °F]
Standards/approvals	cULus listed per UL 104 Complies with ANSI/ASME A17.1, A18.1 Complies with CAN/CSA B44
Electrical rating	0.20 A max., 24 Vdc 0.35 A max., 24 Vac, 60 Hz

DESIGN FEATURES

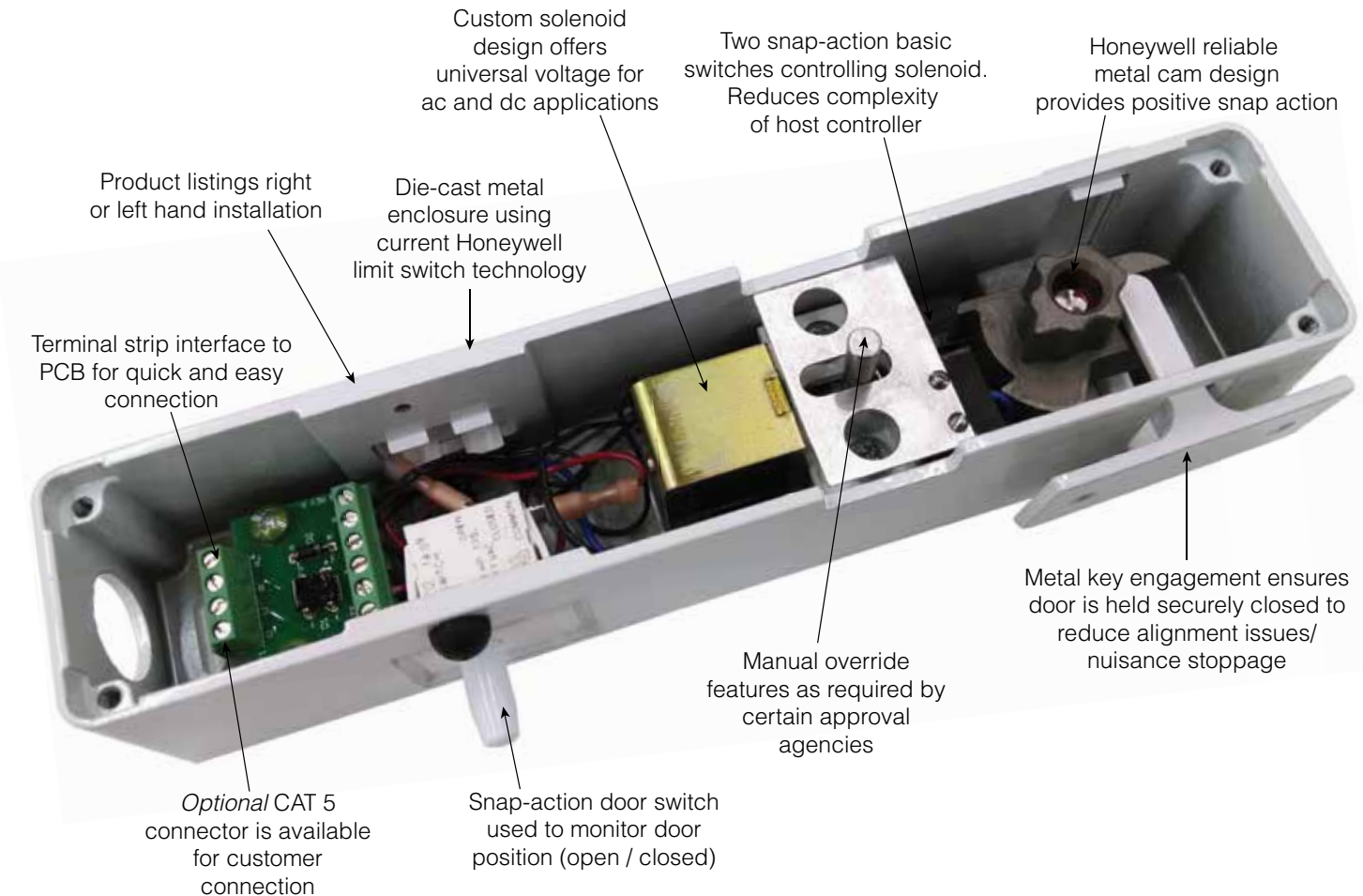

Commercial Door Interlock Switch

NOMENCLATURE TREE

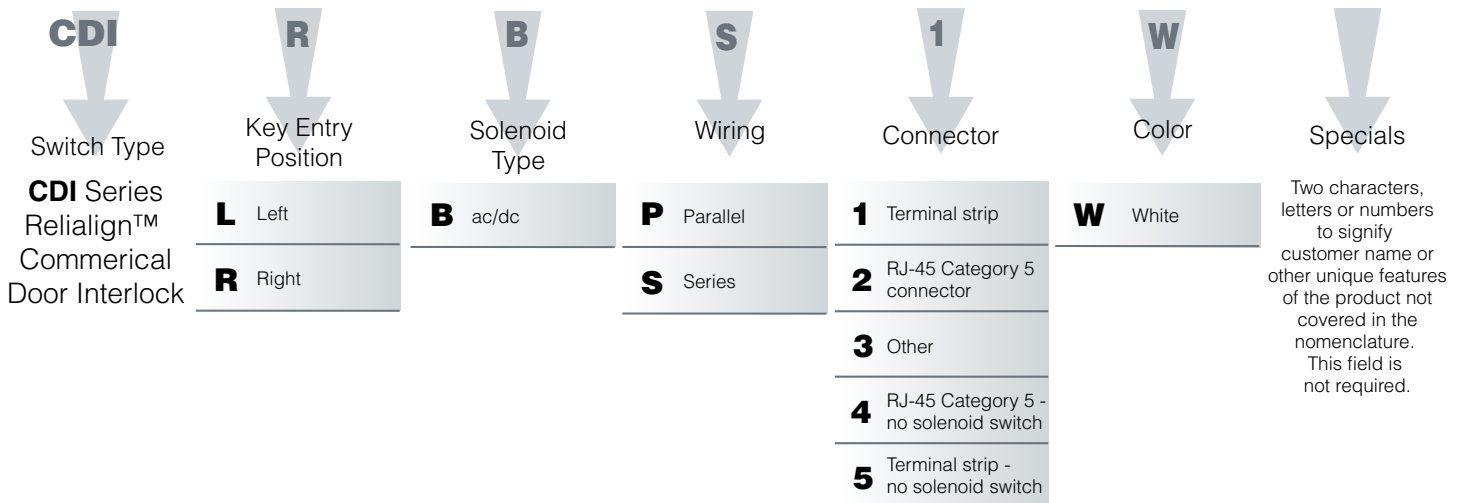

TABLE 2. STANDARD LISTINGS

Part Number	Description
CDILBP1W	White CDI Series Commercial Door Interlock, left key entry, ac/dc solenoid, parallel wiring, terminal strip connector
CDIRBP1W	White CDI Series Commercial Door Interlock, right key entry, ac/dc solenoid, parallel wiring, terminal strip connector
CDILBP2W	White CDI Series Commercial Door Interlock, left key entry, ac/dc solenoid, parallel wiring, RJ-45 Category 5 connector
CDIRBP2W	White CDI Series Commercial Door Interlock, right key entry, ac/dc solenoid, parallel wiring, RJ-45 Category 5 connector
CDILBS1W	White CDI Series Commercial Door Interlock, left key entry, ac/dc solenoid, series wiring, terminal strip connector
CDIRBS1W	White CDI Series Commercial Door Interlock, right key entry, ac/dc solenoid, series wiring, terminal strip connector
CDILBS2W	White CDI Series Commercial Door Interlock, left key entry, ac/dc solenoid, series wiring, RJ-45 Category 5 connector
CDIRBS2W	White CDI Series Commercial Door Interlock, right key entry, ac/dc solenoid, series wiring, RJ-45 Category 5 connector

⚠ WARNING
RISK TO LIFE OR PROPERTY

Never use this product for an application involving serious risk to life or property without ensuring that the system as a whole has been designed to address the risks, and that this product is property rated and installed for the intended use within the overall system.

Failure to comply with these instructions could result in death or serious injury.

⚠ WARNING
PERSONAL INJURY

DO NOT USE these products as safety or emergency stop devices or in any other application where failure of the product could result in personal injury.

Failure to comply with these instructions could result in death or serious injury.

Warranty. Honeywell warrants goods of its manufacture as being free of defective materials and faulty workmanship. Honeywell's standard product warranty applies unless agreed to otherwise by Honeywell in writing; please refer to your order acknowledgement or consult your local sales office for specific warranty details. If warranted goods are returned to Honeywell during the period of coverage, Honeywell will repair or replace, at its option, without charge those items it finds defective. **The foregoing is buyer's sole remedy and is in lieu of all warranties, expressed or implied, including those of merchantability and fitness for a particular purpose. In no event shall Honeywell be liable for consequential, special, or indirect damages.**

While we provide application assistance personally, through our literature and the Honeywell web site, it is up to the customer to determine the suitability of the product in the application.

Specifications may change without notice. The information we supply is believed to be accurate and reliable as of this printing. However, we assume no responsibility for its use.

Find out more

Honeywell serves its customers through a worldwide network of sales offices, representatives and distributors. For application assistance, current specifications, pricing or name of the nearest Authorized Distributor, contact your local sales office. To learn more about Honeywell's sensing and control products, call **+1-815-235-6847** or **1-800-537-6945**, visit **sensing.honeywell.com**, or e-mail inquiries to **info.sc@honeywell.com**

Sensing and Control
Honeywell
1985 Douglas Drive North
Golden Valley, MN 55422
honeywell.com