

DRAWING MADE IN THIRD ANGLE PROJECTION
 THIS DRAWING IS UNPUBLISHED. RELEASED FOR PUBLICATION , 19 .
 © COPYRIGHT 19 BY AMP INCORPORATED. ALL INTERNATIONAL RIGHTS RESERVED.

| LOC | | DIST | | REV | | ZONE | | LTR | | REVISIONS | | DATE | APPD |
|-----|----|------|--|-----|--|------|--|-----|--|----------------------|----------|-------|------|
| AF | 50 | | | | | | | B | | REV PER 0L10-0054-96 | 11/13/96 | JR/PD | |

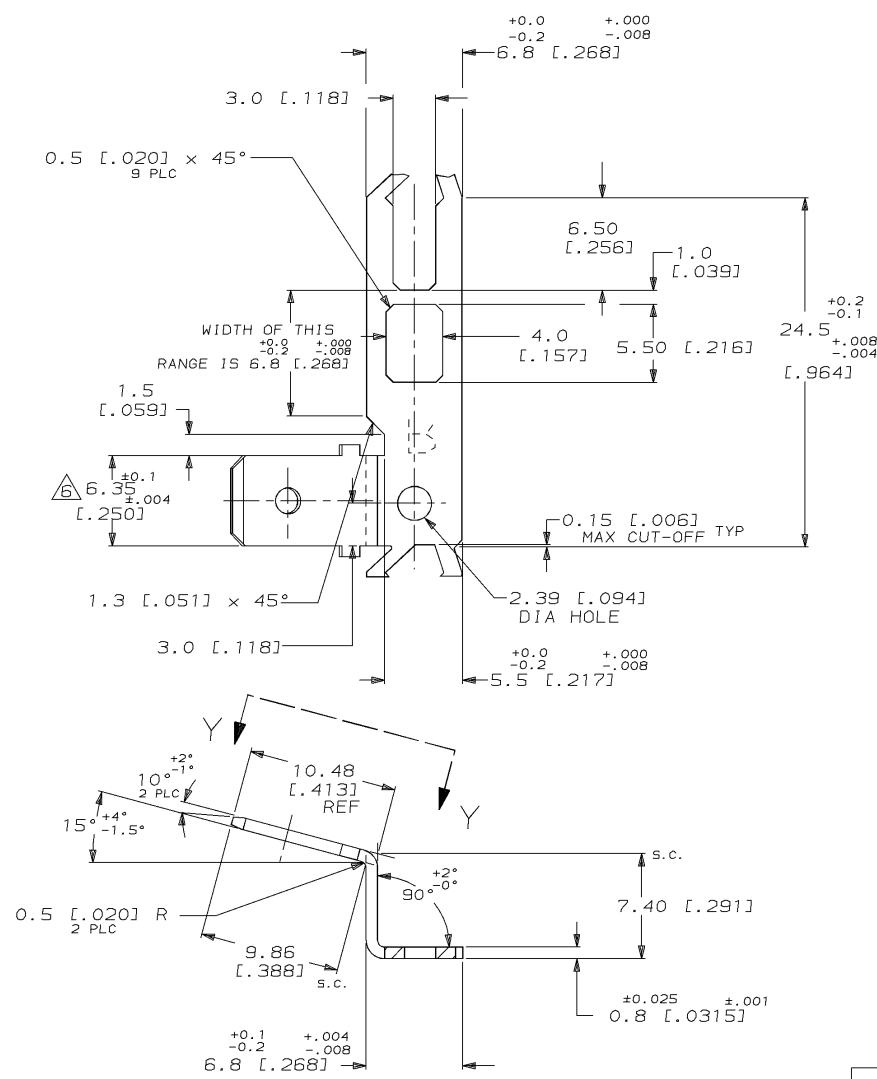

- 1 TIN PLATE 3um [0.00120] MIN OVER 1um [0.00040] MIN COPPER.
- 2 THE FLASH SHOULD BE LESS THAN 0.02mm [0.0008].
- 3 THE WARP SHOULD BE LESS THAN 0.2mm [0.008].
- 4 PLATED SURFACE SHOULD BE MATTE FINISH.
- 5 MASBAC P/N BLC2GFO0016.
- 6 6.35 DIMENSION MAY GROW A MAXIMUM OF 0.06 MM AT THE BEND.

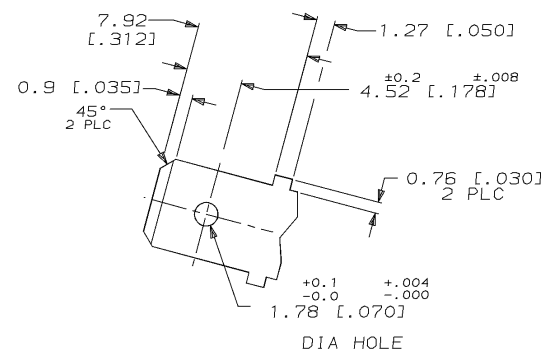

VIEW Y-Y

63790-1
PART NO

| | | | | | |
|---|--|---------------------------|--|--|--|
| DO NOT SCALE PRINT. UNLESS SPECIFIED DIMENSIONS IN mm [INCHES] TOLERANCES ON : 2 PLC DEC ± 0.13 [0.005] 3 PLC DEC ± - ANGLES ± - | | DR 6/6/94 JR RUTH | | AMP Incorporated Harrisburg, PA 17105-3608 | |
| MATERIAL BRASS C2600 1/2H OR C2680 1/2H | | CHK 6/6/94 MS FEHER | | | |
| FINISH △ | | APPD 6/6/94 P DESANTIS | | NAME | |
| | | APPD 6/6/94 R REINER | | TAB, FASTON, 6.35 [0.250] SERIES RIGHT HAND | |
| | | PRODUCT SPEC | | SIZE | |
| | | APPLICATION SPEC | | CAGE CODE | |
| | | - | | 00779 | |
| | | WEIGHT | | DRAWING NO | |
| | | - | | C=63790 | |
| | | | | SCALE 4:1 | |
| | | | | SHEET 1 OF 1 | |

THIS DRAWING IS A CONTROLLED DOCUMENT FOR AMP INCORPORATED. IT IS SUBJECT TO CHANGE AND THE CONTROLLING ENGINEERING ORGANIZATION SHOULD BE CONTACTED FOR THE LATEST REVISION.